

CITY OF SALFORD UNITARY DEVELOPMENT PLAN REVIEW PROPOSED MODIFICATION TO THE PROPOSALS MAP

- Address: Land at the junction of Vicars Hall Lane & Leigh Road, Worsley & Boothstown
- Policy: Policy EHC8
- Modification: Delete the policy from the Proposals Map

MOD 535

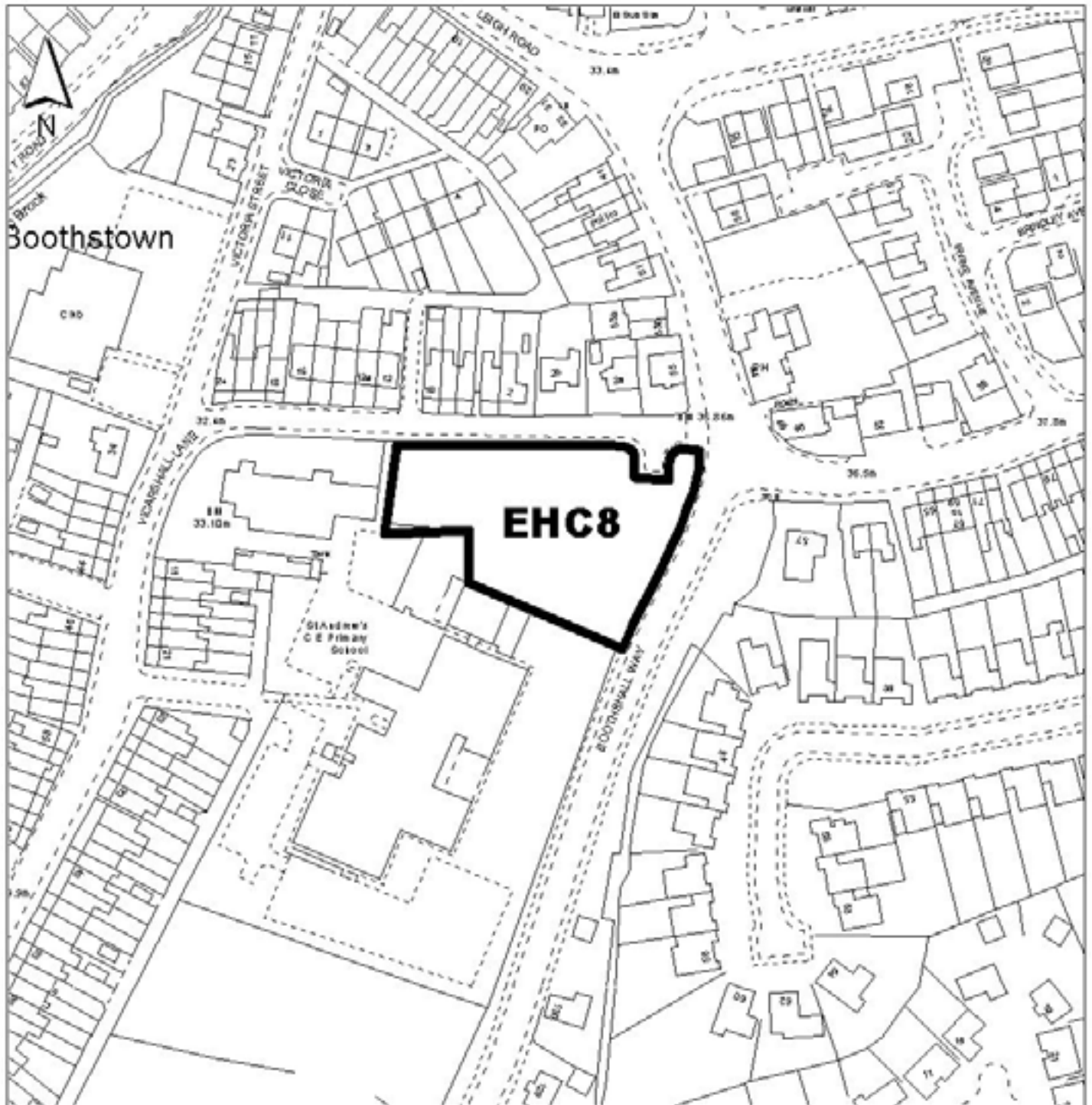

Salford City Council

Development Planning Section,
Development Services,
Salford Civic Centre, Chorley Rd,
Swinton, Salford M27 5BW,
www.salford.gov.uk

Job:	
Drawn:	
Checked:	
Scale:	1:1500
Date:	Oct 2005
Filename:	UDPMOD

Project:

Drawing No.

Title:

Revision

Reproduced from the Ordnance Survey mapping with the permission of the Controller of Her Majesty's Stationery Office © Crown copyright.
Unauthorised reproduction infringes Crown copyright and may lead to prosecution or civil proceedings. Salford City Council. Licence No. 100019737. 2004.

epc-modifications-to-proposals-map.apr

CITY OF SALFORD UNITARY DEVELOPMENT PLAN REVIEW PROPOSED MODIFICATION TO THE PROPOSALS MAP

- Address: The A57 - M62 Barton Moss link road
- Policy: Policy A9/3
- Modification: Delete the policy from the Proposals Map

MOD 536

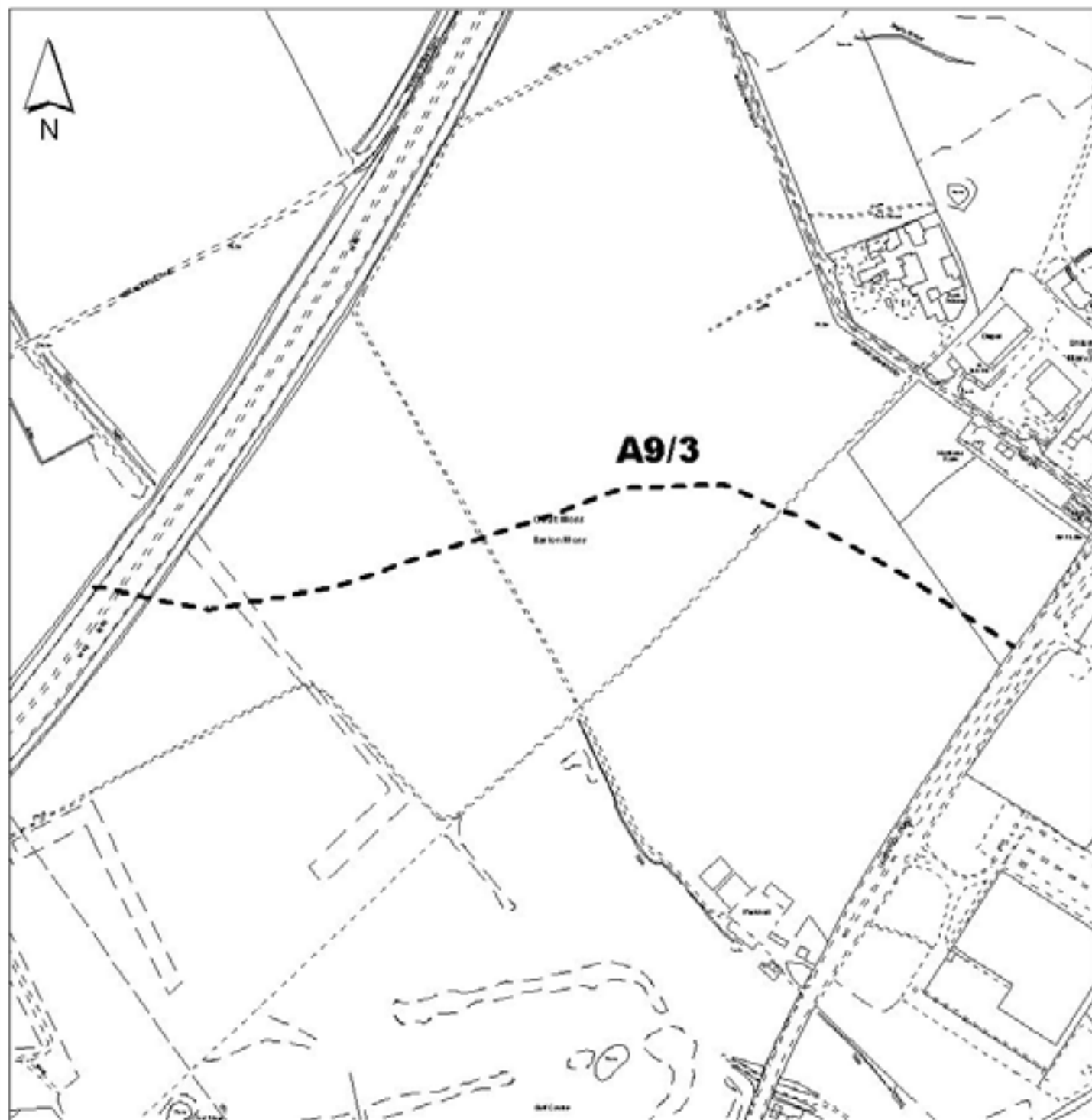

Salford City Council Development Planning Section, Development Services, Salford Civic Centre, Chorley Rd, Swinton, Salford M27 5BW, www.salford.gov.uk	Job:	Project:	Drawing No.
	Drawn:		
	Checked:		
	Scale: 1:5500	Title:	Revision:
Date: Oct 2005			
Filename: UDPMOD			

*Reproduced from the Ordnance Survey mapping with the permission of the Controller of Her Majesty's Stationery Office © Crown copyright. Unauthorised reproduction infringes Crown copyright and may lead to prosecution or civil proceedings. Salford City Council. Licence No. 100019737. 2004.

CITY OF SALFORD UNITARY DEVELOPMENT PLAN REVIEW PROPOSED MODIFICATION TO THE PROPOSALS MAP

- Address: A580 - B5231 Link Road (East Lancashire Road to Rocky Lane)
- Policy: Policy A9/5
- Modification: Delete the policy from the Proposals Map

MOD 537

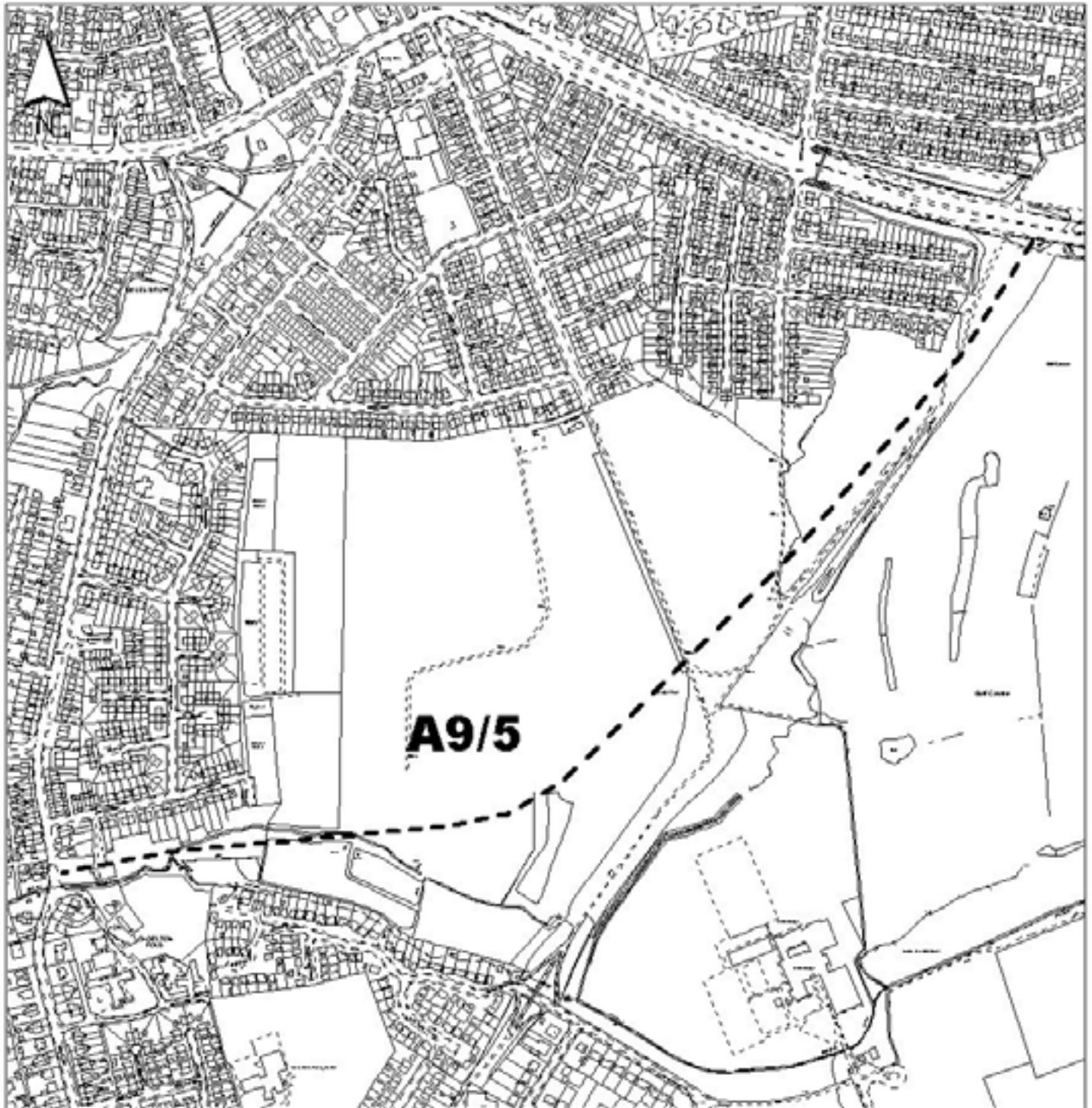

Salford City Council Development Planning Section, Development Services, Salford Civic Centre, Chorley Rd, Swinton, Salford M27 8BW, www.salford.gov.uk	Job:	Project:	Drawing No.
	Drawn:		
	Checked:		
	Scale: 1:6000	Type:	Revision:
	Date: Oct 2005		
Filename: UDPMOD			

*Reproduced from the Ordnance Survey mapping with the permission of the Controller of Her Majesty's Stationery Office © Crown copyright. Unauthorised reproduction infringes Crown copyright and may lead to prosecution or civil proceedings. Salford City Council, Licence No. 100019737, 2004.

CITY OF SALFORD UNITARY DEVELOPMENT PLAN REVIEW PROPOSED MODIFICATION TO THE PROPOSALS MAP

- Address: A57 - A6144 Link road and lift bridge (Cadishead Way (Salford) to Manchester Road (Trafford))
- Policy: Policy A9/6
- Modification: Delete the policy from the Proposals Map

MOD 538

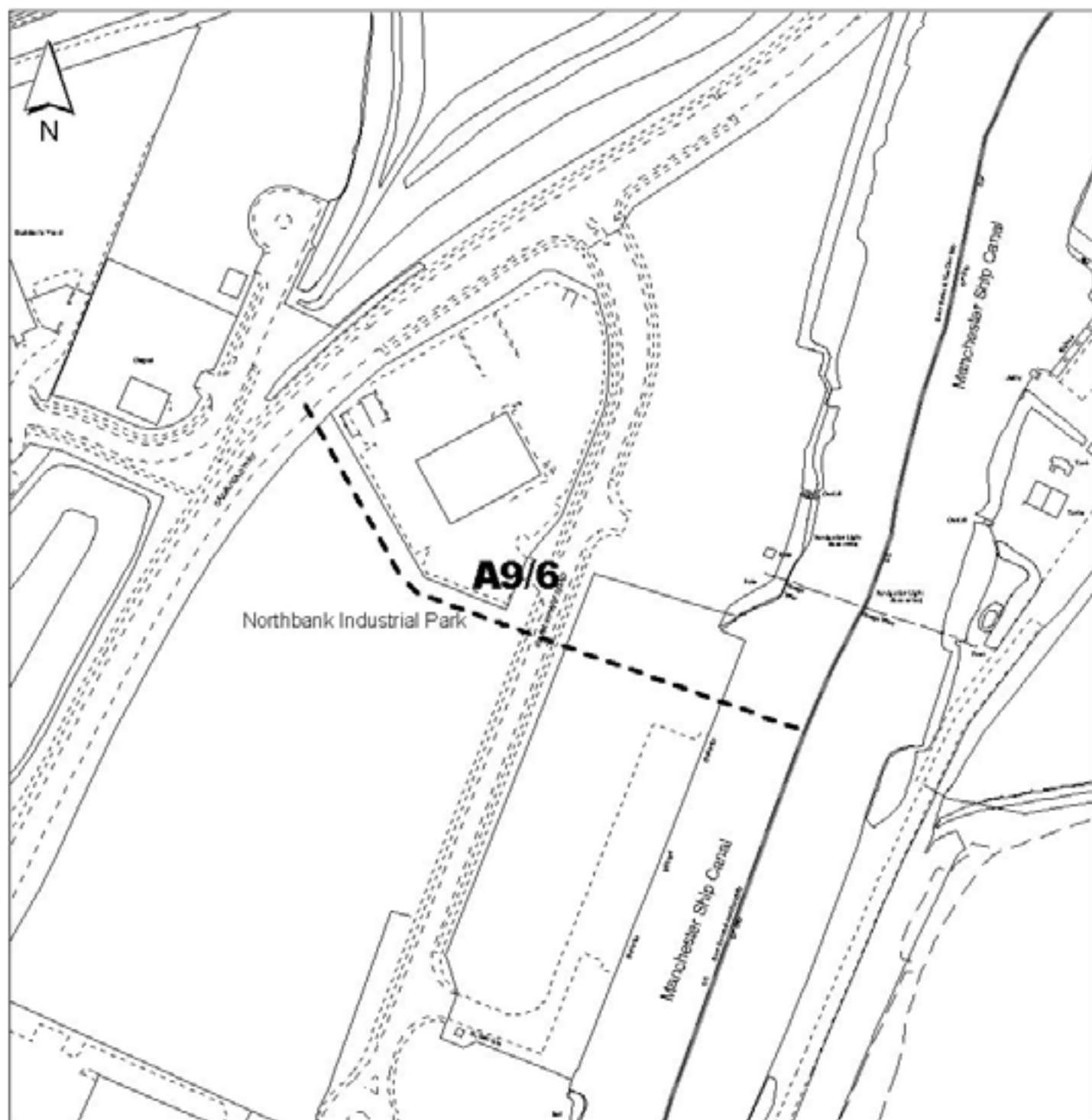

Salford City Council Development Planning Section, Development Services, Salford Civic Centre, Chorley Rd, Swinson, Salford M27 5BW, www.salford.gov.uk	Job:	Project:	Drawing No.
	Drawn:		
	Checked:		
	Scale: 1:2500	Title:	Revision:
	Date: Oct 2005		
Filename: UDPMOD			

*Reproduced from the Ordnance Survey mapping with the permission of the Controller of Her Majesty's Stationery Office © Crown copyright. Unauthorised reproduction infringes Crown copyright and may lead to prosecution or civil proceedings. Salford City Council. Licence No. 100019737, 2004.

CITY OF SALFORD UNITARY DEVELOPMENT PLAN REVIEW PROPOSED MODIFICATION TO THE PROPOSALS MAP

- Address: Irwell Valley (Land at Rake Lane)
- Policy: Policy ENG
- Modification: Delete land within the garden of number 279 Rake Lane, Clifton, from the policy area

MOD 539

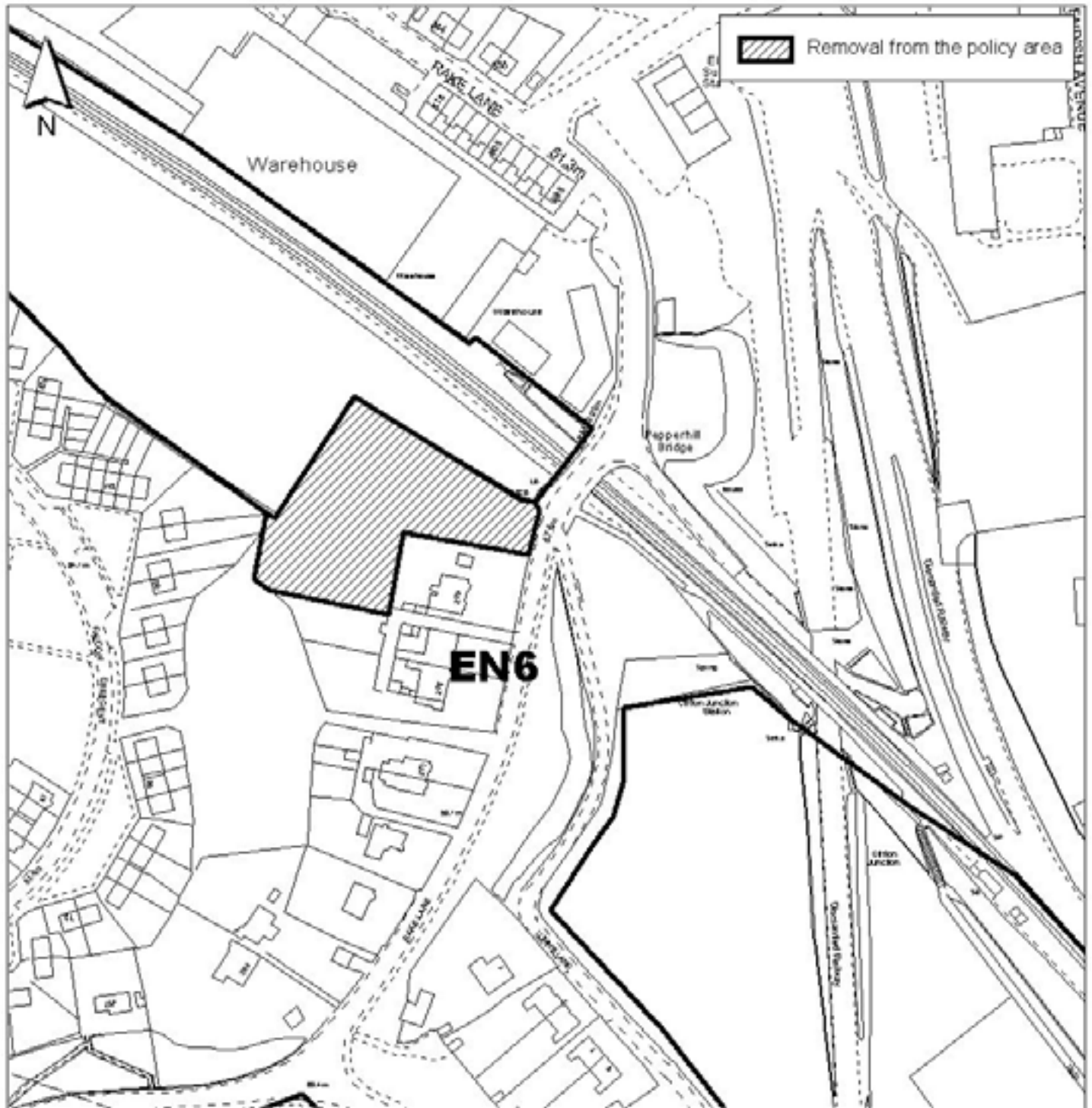

<p>Salford City Council</p> <p>Development Planning Section, Development Services, Salford Civic Centre, Chorley Rd, Swinton, Salford M27 8BW, www.salford.gov.uk</p>	Job:	Project:	Drawing No.
	Drawn:		
	Checked:		
	Scale: 1:2000	Type:	Revision:
	Date: Oct 2005		
Filename: UDPMOD			

*Reproduced from the Ordnance Survey mapping with the permission of the Controller of Her Majesty's Stationery Office © Crown copyright. Unauthorised reproduction infringes Crown copyright and may lead to prosecution or civil proceedings. Salford City Council, Licence No. 100019737, 2004.

CITY OF SALFORD UNITARY DEVELOPMENT PLAN REVIEW PROPOSED MODIFICATION TO THE PROPOSALS MAP

- Address: Twelve Yards Road, Irlam
- Policy: Policy EN7C
- Modification: Allocate land at Twelve Yards Road as a Site of Biological Importance

MOD 540

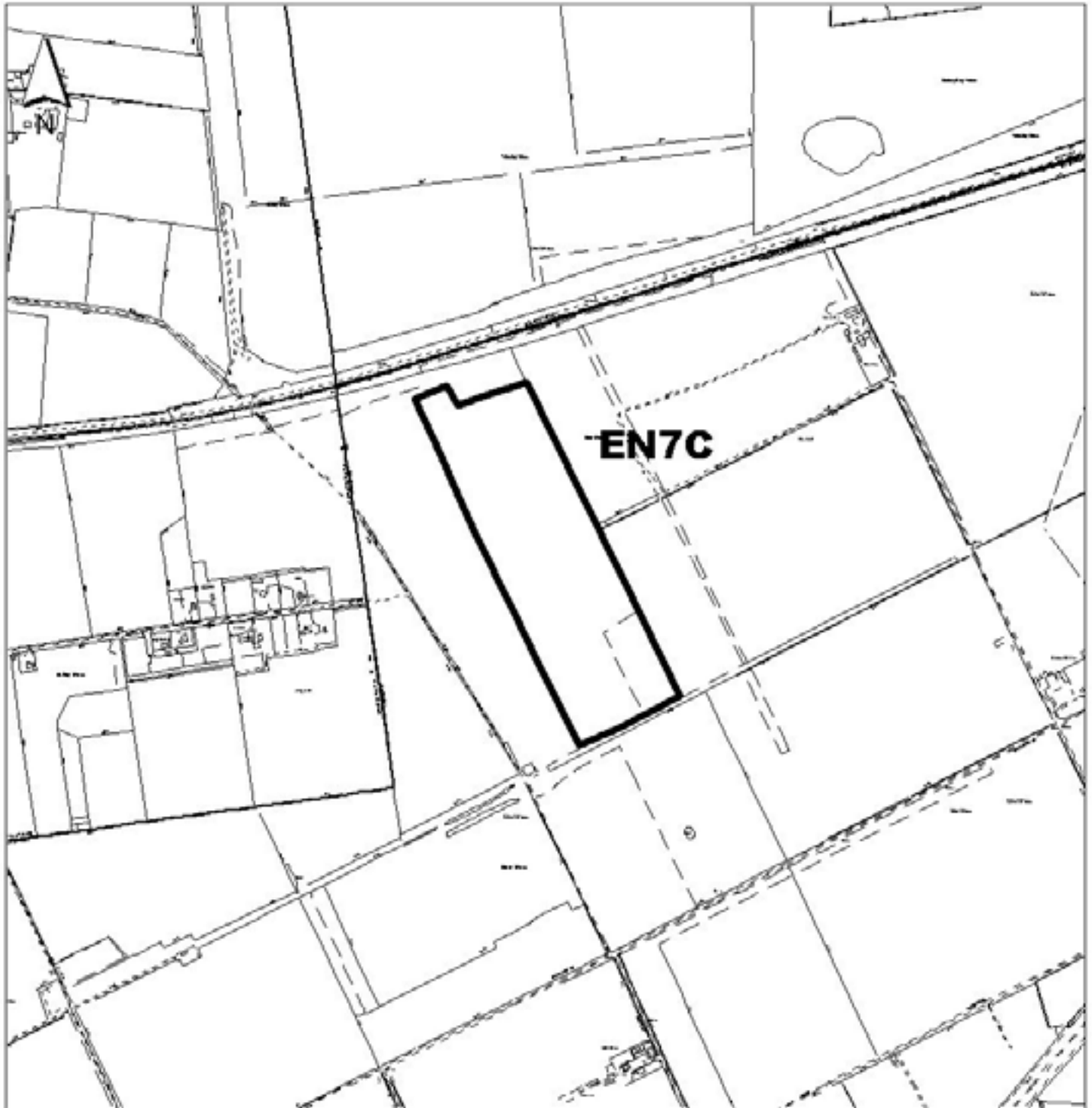

Salford City Council Development Planning Section, Development Services, Salford Civic Centre, Chorley Rd, Swinton, Salford M27 8BW, www.salford.gov.uk	Job:	Project:	Drawing No.
	Drawn:		
	Checked:		
	Scale: 1:11000	Type:	Revision:
Date: Oct 2005			
Filename: UDPMOD			

*Reproduced from the Ordnance Survey mapping with the permission of the Controller of Her Majesty's Stationery Office © Crown copyright. Unauthorised reproduction infringes Crown's copyright and may lead to prosecution or civil proceedings. Salford City Council, Licence No. 100019737, 2004.

CITY OF SALFORD UNITARY DEVELOPMENT PLAN REVIEW PROPOSED MODIFICATION TO THE PROPOSALS MAP

MOD 541

- Address: **Wildlife Corridor (Land at Rake Lane)**
- Policy: **Policy EN7D**
- Modification: **Delete land within the garden of number 279 Rake Lane, Clifton, from the Wildlife Corridor Key Area of Search**

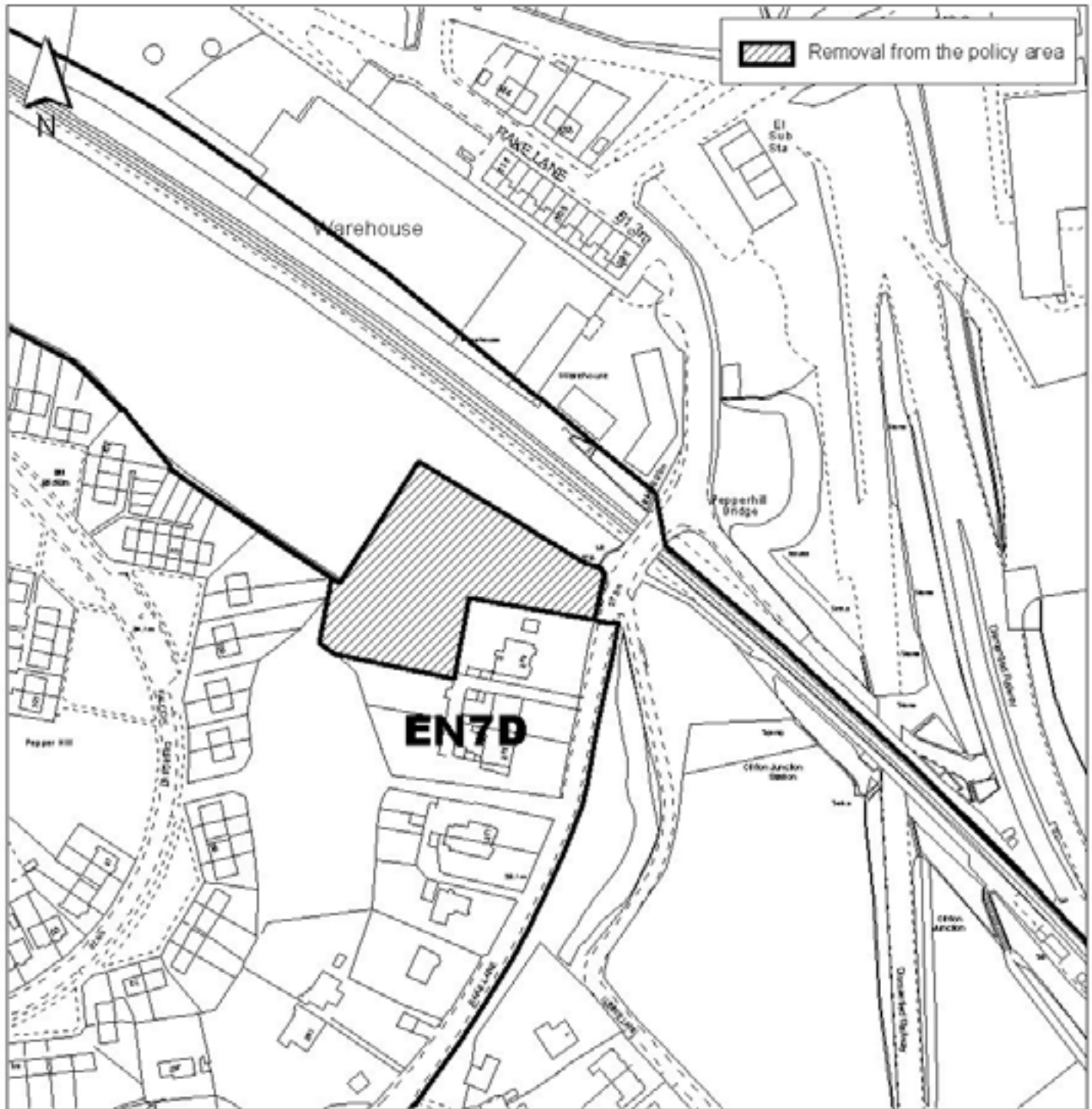

Salford City Council Development Planning Section, Development Services, Salford Civic Centre, Chorley Rd, Swinton, Salford M27 5BW, www.salford.gov.uk	Job:	Project:	Drawing No.
	Drawn:		
	Checked:		
	Scale: 1:2000	Title:	Revision:
Date: Oct 2005			
Filename: UDPMOD			

*Reproduced from the Ordnance Survey mapping with the permission of the Controller of Her Majesty's Stationery Office © Crown copyright. Unauthorised reproduction infringes Crown copyright and may lead to prosecution or civil proceedings. Salford City Council. Licence No. 100019737. 2004.

CITY OF SALFORD UNITARY DEVELOPMENT PLAN REVIEW PROPOSED MODIFICATION TO THE PROPOSALS MAP

- **Address:** Wildlife Corridor (Land at Liverpool Road / Cadishead Way)
- **Policy:** Policy EN7D
- **Modification:** Delete land bounded by Liverpool Road, Cadishead Way and draft housing allocation H9/30 from the Wildlife Corridor Key Area of Search

MOD 542

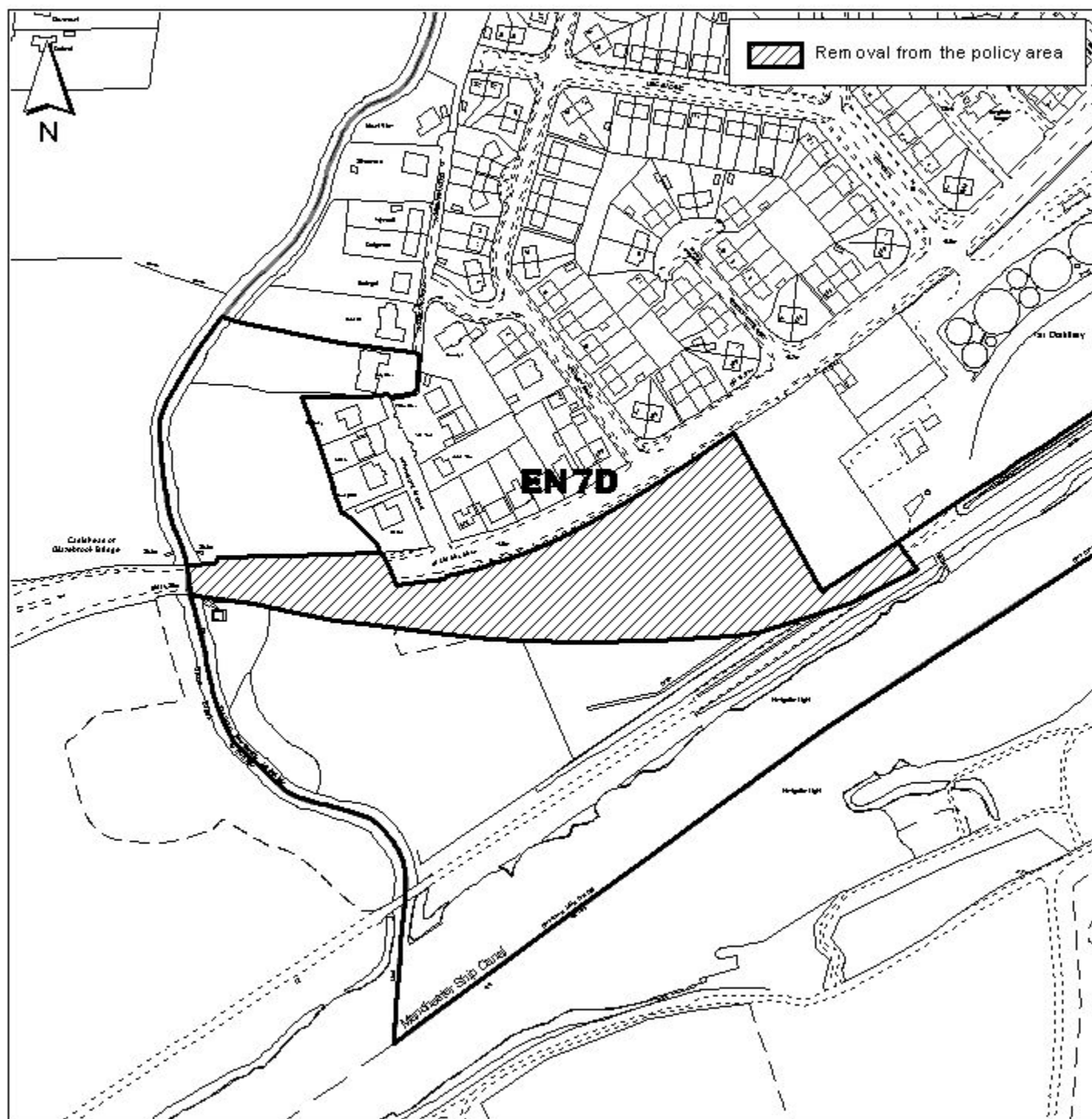

Salford City Council

Development Planning Section,
Development Services,
Salford Civic Centre, Chorley Rd,
Swinton, Salford M27 6BW,
www.salford.gov.uk

Job:
Drawn:
Checked:
Scale: 1:3000
Date: Oct 2005
Filename: UDP MOD

Project:

Title:

Drawing No.

Revision

'Reproduced from the Ordnance Survey mapping with the permission of the Controller of Her Majesty's Stationary Office © Crown copyright.
Unauthorized reproduction infringes Crown copyright and may lead to prosecution or civil proceedings. Salford City Council. Licence No. 100019737. 2004.

[udp.modifications.to.proposals.map.apr](#)

CITY OF SALFORD UNITARY DEVELOPMENT PLAN REVIEW PROPOSED MODIFICATION TO THE PROPOSALS MAP

- Address: World Heritage Site
- Policy: Policy CH1
- Modification: Delete the policy from the proposals map

MOD 543

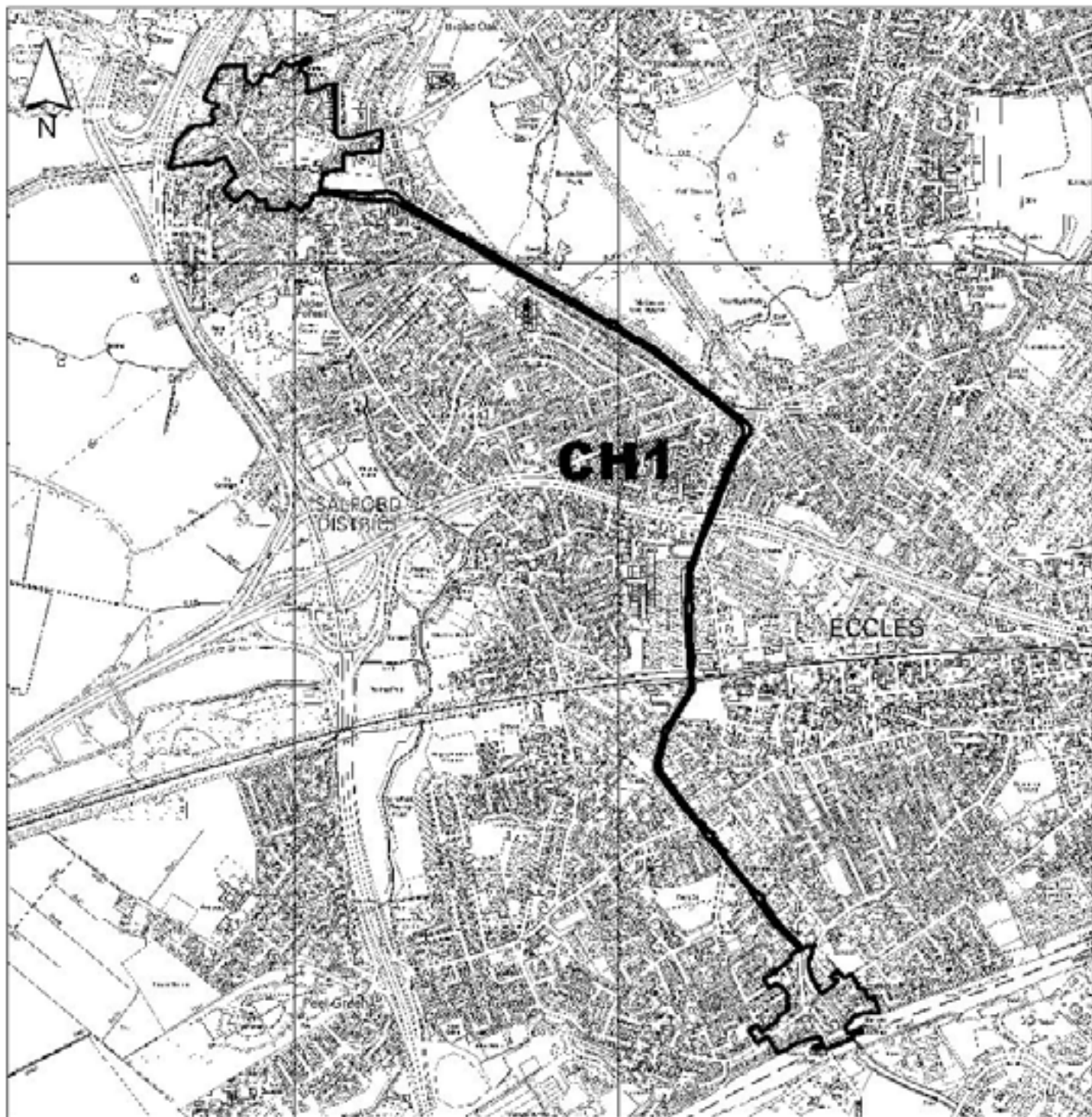

<p>Salford City Council</p> <p>Development Planning Section, Development Services, Salford Civic Centre, Chorley Rd, Swinson, Salford M27 5BW. www.salford.gov.uk</p>	Job:	Project:	Drawing No.
	Drawn:		
	Checked:		
	Scale: 1:18000	Title:	Revision:
	Date: Oct 2005		
Filename: UDPMOD			

*Reproduced from the Ordnance Survey mapping with the permission of the Controller of Her Majesty's Stationery Office © Crown copyright. Unauthorised reproduction infringes Crown copyright and may lead to prosecution or civil proceedings. Salford City Council. Licence No. 100019737, 2004.

CITY OF SALFORD UNITARY DEVELOPMENT PLAN REVIEW PROPOSED MODIFICATION TO THE PROPOSALS MAP

MOD 544

- Address: **Cliff Conservation Area**
- Policy: **Policy CH5/5**
- Modification: **Amend the boundary of the Cliff Conservation Area to include land east of Grecian Street North and south of Grecian Street North Primary School**

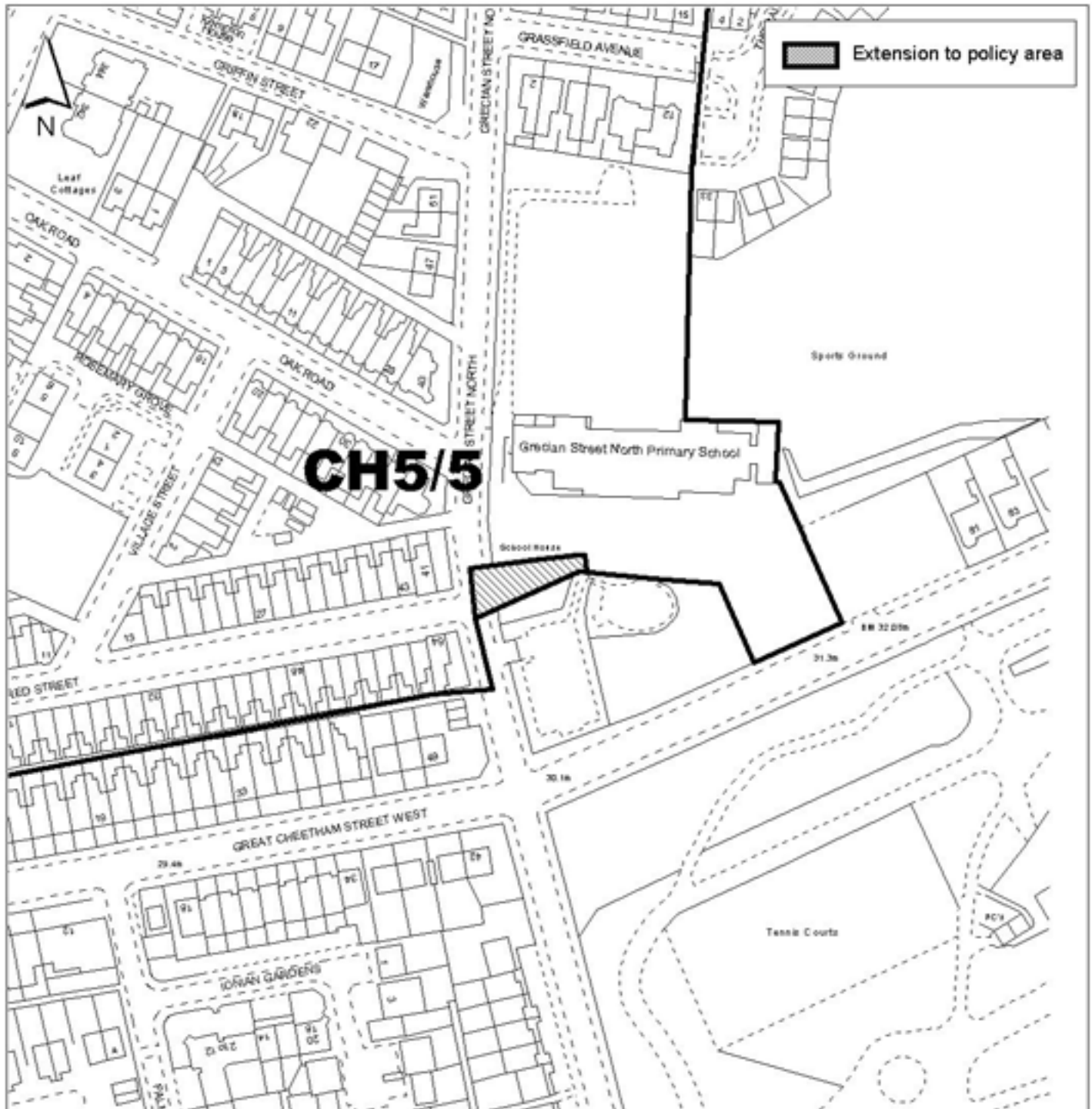

Salford City Council

Development Planning Section,
Development Services,
Salford Civic Centre, Chorley Rd,
Swinton, Salford M27 5BW,
www.salford.gov.uk

Job:	
Drawn:	
Checked:	
Scale:	1:1500
Date:	Oct 2005
Filename:	UDPMOD

Project:

Title:

Drawing No.

Revision

Reproduced from the Ordnance Survey mapping with the permission of the Controller of Her Majesty's Stationery Office © Crown copyright.
Unauthorised reproduction infringes Crown copyright and may lead to prosecution or civil proceedings. Salford City Council. Licence No. 100019737. 2004.

udp modifications to proposals map.apr

CITY OF SALFORD UNITARY DEVELOPMENT PLAN REVIEW PROPOSED MODIFICATION TO THE PROPOSALS MAP

- Address: Blackleach Country Park
- Policy: Policy R4/1
- Modification: Amend the boundary of Blackleach Country Park Key Recreation Area to include land north of Hill Top Road and east of Bolton Road

MOD 545

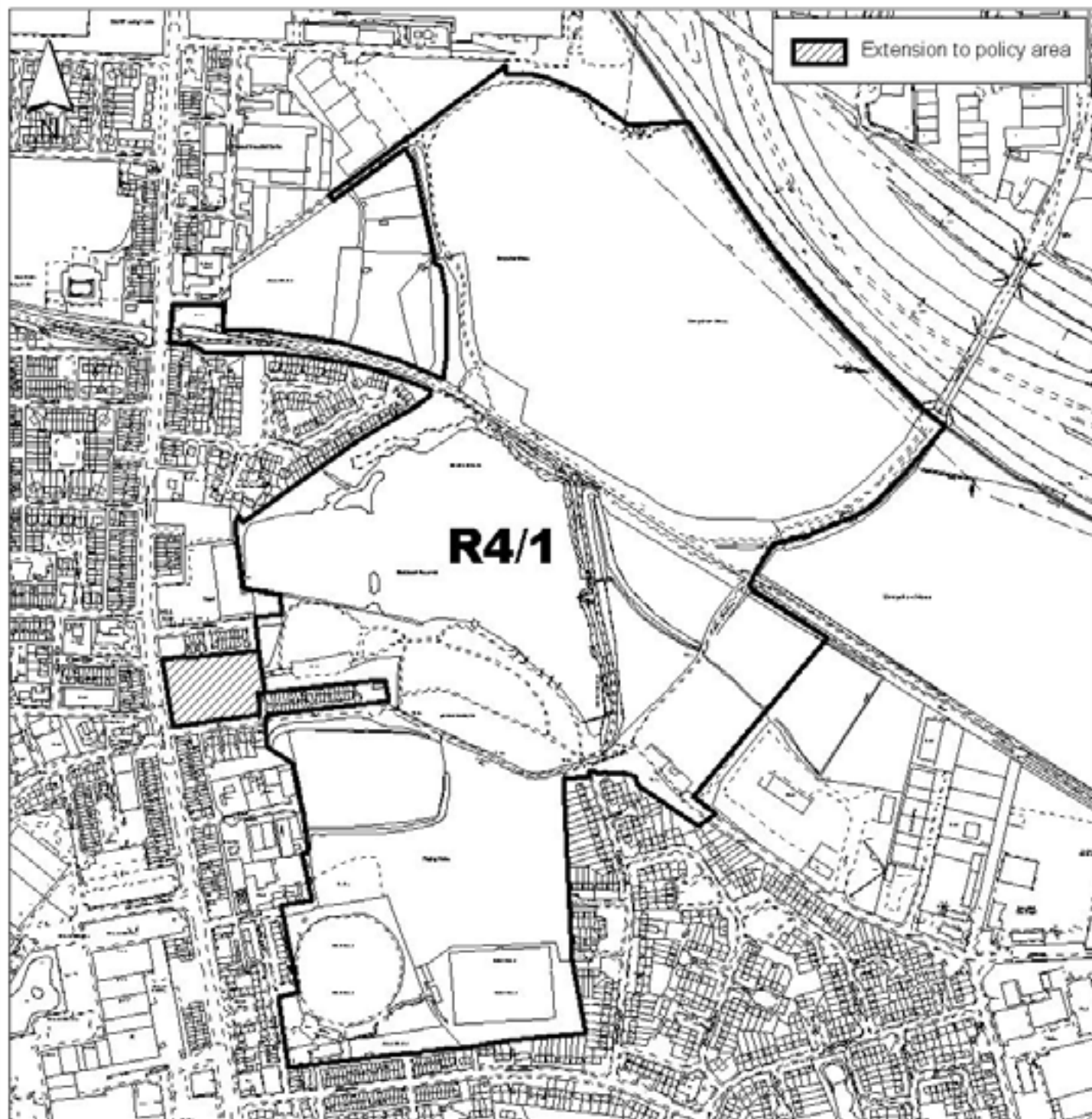

Salford City Council

Development Planning Section,
Development Services,
Salford Civic Centre, Chorley Rd,
Swinson, Salford M27 5BW,
www.salford.gov.uk

Job:	Project:	Drawing No.
Drawn:		
Checked:		
Scale: 1:6000	Title:	Revision:
Date: Oct 2005		
Filename: UDPMOD		

Reproduced from the Ordnance Survey mapping with the permission of the Controller of Her Majesty's Stationery Office © Crown copyright.
Unauthorised reproduction infringes Crown copyright and may lead to prosecution or civil proceedings. Salford City Council. Licence No. 100019737, 2004.

CITY OF SALFORD UNITARY DEVELOPMENT PLAN REVIEW PROPOSED MODIFICATION TO THE PROPOSALS MAP

- Address: Bradford Road to Monton Road
- Policy: Policy R5
- Modification: Additional Existing Strategic Recreation Route

MOD 546



<p>Salford City Council</p> <p>Development Planning Section, Development Services, Salford Civic Centre, Chorley Rd, Swinton, Salford M27 8BW, www.salford.gov.uk</p>	Job:	Project:	Drawing No.
	Drawn:		
	Checked:		
	Scale: 1:4500	Type:	Revision:
Date: Oct 2005			
Filename: UDPMOD			

*Reproduced from the Ordnance Survey mapping with the permission of the Controller of Her Majesty's Stationery Office © Crown copyright. Unauthorised reproduction infringes Crown copyright and may lead to prosecution or civil proceedings. Salford City Council, Licence No. 100019737, 2004.

CITY OF SALFORD UNITARY DEVELOPMENT PLAN REVIEW PROPOSED MODIFICATION TO THE PROPOSALS MAP

- Address: Duncan Mathieson Playing Fields and adjoining land
- Policy: Policy R6/3
- Modification: Amend allocation from 'land adjoining Duncan Mathieson Playing Fields' to 'The Duncan Mathieson Playing Fields and adjoining land'.

MOD 547

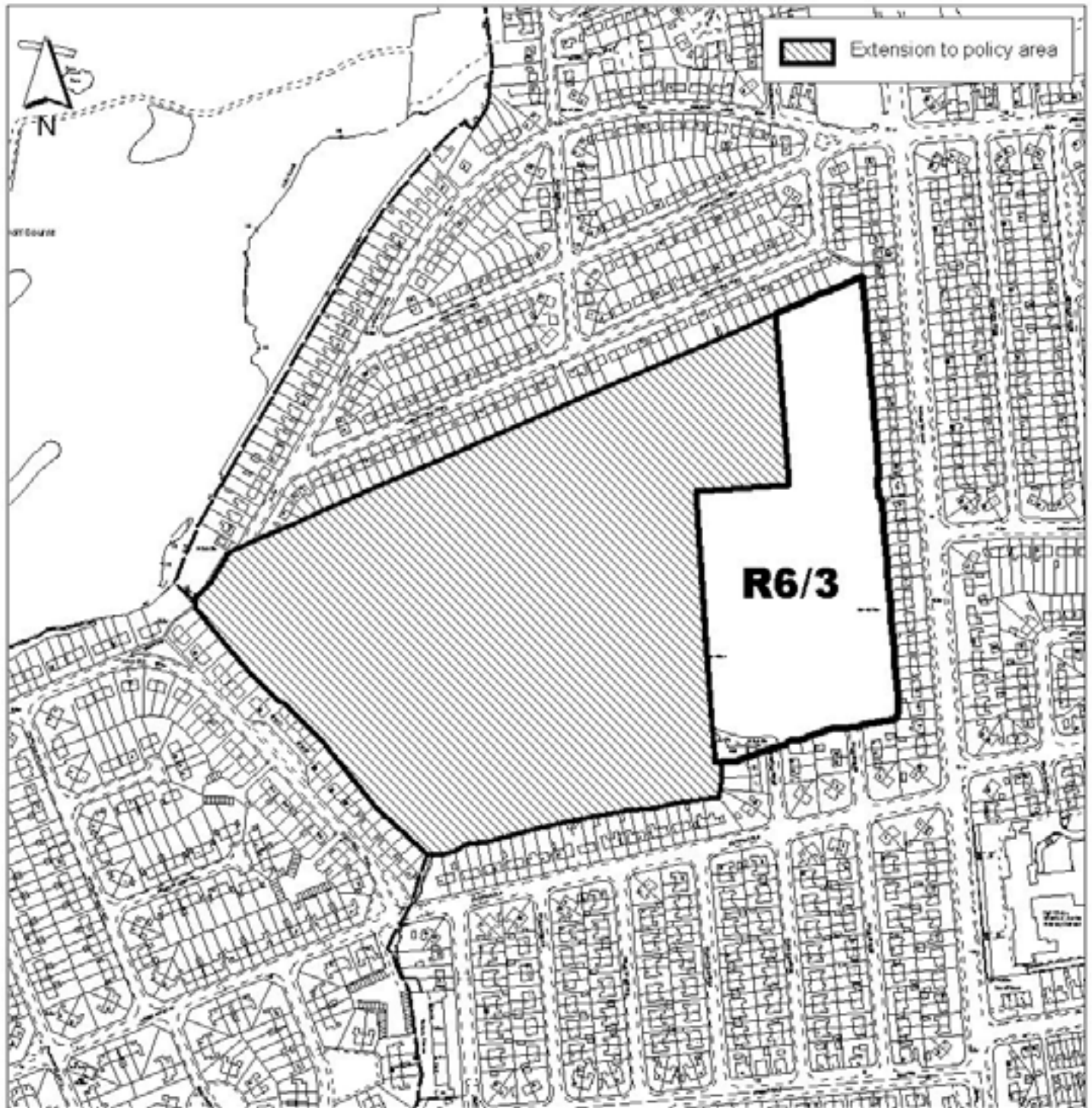

Salford City Council Development Planning Section, Development Services, Salford Civic Centre, Chorley Rd, Swinton, Salford M27 8BW, www.salford.gov.uk	Job:	Project:	Drawing No.
	Drawn:		
	Checked:		
	Scale: 1:4000	Type:	Revision:
	Date: Oct 2005		
Filename: UDPMOD			

*Reproduced from the Ordnance Survey mapping with the permission of the Controller of Her Majesty's Stationery Office © Crown copyright. Unauthorised reproduction infringes Crown's copyright and may lead to prosecution or civil proceedings. Salford City Council. Licence No. 100019737. 2004.

CITY OF SALFORD UNITARY DEVELOPMENT PLAN REVIEW PROPOSED MODIFICATION TO THE PROPOSALS MAP

- Address: Alder Forest, Winton

- Policy: Policy R6/16

- Modification: Delete land to the north west of the footpath leading to Granary Lane and to the rear of residential gardens on Rycroft Lane from the policy

MOD 548

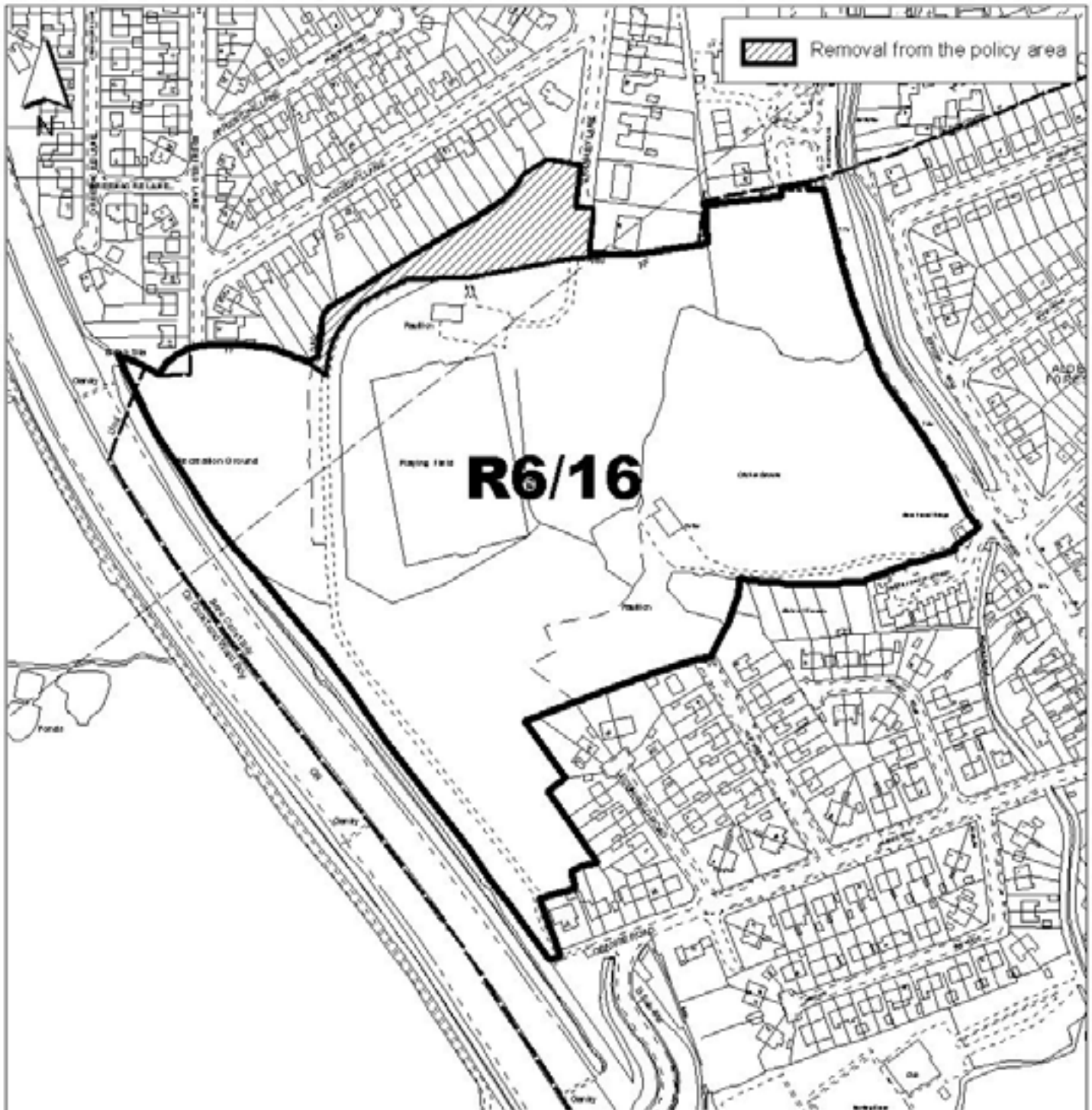

Salford City Council

Development Planning Section,
Development Services,
Salford Civic Centre, Chorley Rd,
Swinton, Salford M27 8BW,
www.salford.gov.uk

Job:	Project:	Drawing No.
Drawn:		
Checked:		
Scale: 1:3200	Title:	Revision
Date: Oct 2005		
Filename: UDPMOD		

*Reproduced from the Ordnance Survey mapping with the permission of the Controller of Her Majesty's Stationery Office © Crown copyright.
Unauthorised reproduction infringes Crown copyright and may lead to prosecution or civil proceedings. Salford City Council, Licence No. 100019737, 2004.

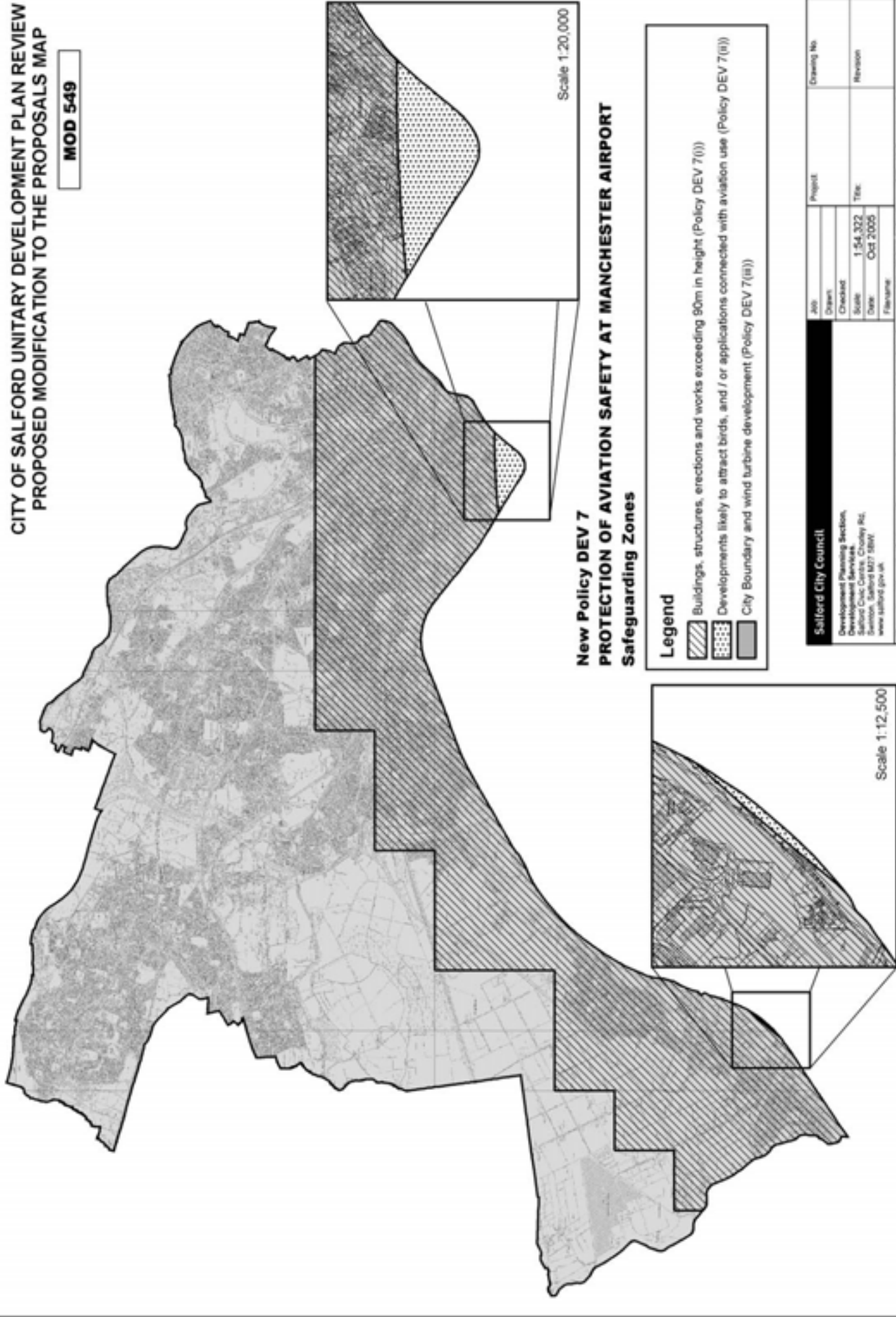

**CITY OF SALFORD UNITARY DEVELOPMENT PLAN REVIEW
PROPOSED MODIFICATION TO THE PROPOSALS MAP**

MOD 549



**New Policy DEV 7
PROTECTION OF AVIATION SAFETY AT MANCHESTER AIRPORT
Safeguarding Zones**

Legend

-  Buildings, structures, erections and works exceeding 90m in height (Policy DEV 7(i))
-  Developments likely to attract birds, and / or applications connected with aviation use (Policy DEV 7(ii))
-  City Boundary and wind turbine development (Policy DEV 7(iii))

Salford City Council

Development Planning Section,
Development Services,
Salford Civic Centre, Churchill Rd,
Salford, Salford M27 5BW,
www.salford.gov.uk

Job	Project	Drawing No.
Drawn		
Checked		
Scale	1:54,322	Title
Date	Oct 2006	Revision
Filename		

Reproduced from the Ordnance Survey mapping with the permission of Her Majesty's Stationery Office © Crown copyright. Unauthorised reproduction infringes Crown copyright and may lead to prosecution or civil proceedings. Salford City Council Licence No. 1000191731, 2004.

CITY OF SALFORD UNITARY DEVELOPMENT PLAN REVIEW
 PROPOSED MODIFICATION TO BE INSERTED INTO THE WRITTEN
 STATEMENT AS APPENDIX 4

MOD 550

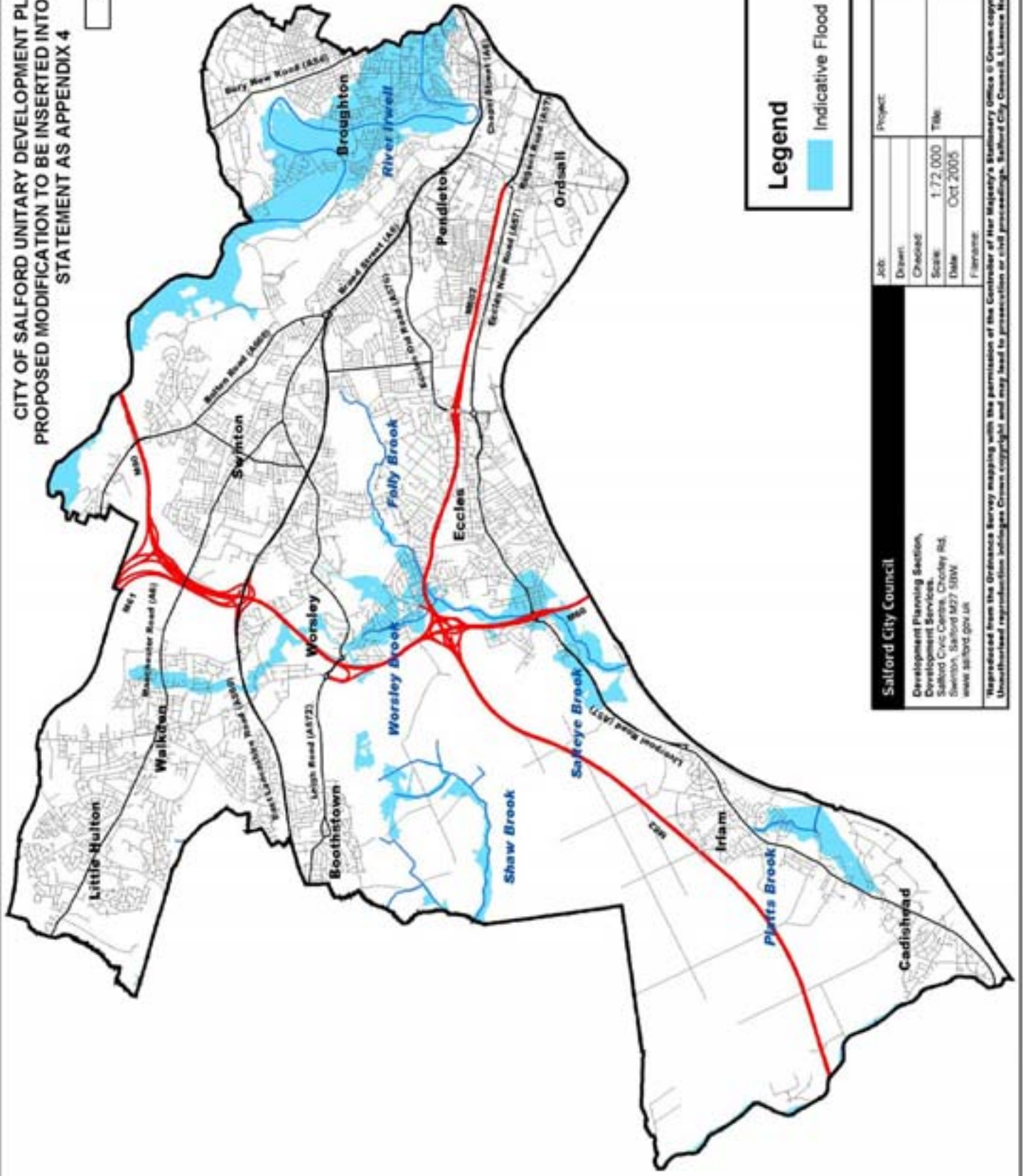

Legend

Indicative Flood Plains (EN16)

Salford City Council

Development Planning Section,
 Development Services,
 Salford Civic Centre, Chorley Rd,
 Salford, Salford M67 5BW,
 www.salford.gov.uk

Job:	Project:	Drawing No:
Drawn:		
Checked:	Title:	Revision:
Scale: 1:72,000		
Date: Oct 2005		
Filename:		
Reproduced from the Ordnance Survey mapping with the permission of the Controller of Her Majesty's Stationery Office © Crown copyright. Unauthorised reproduction infringes Crown copyright and may lead to prosecution or civil proceedings. Salford City Council, Licence No. 100019737, 2004.		